

# BSA-N-4,8

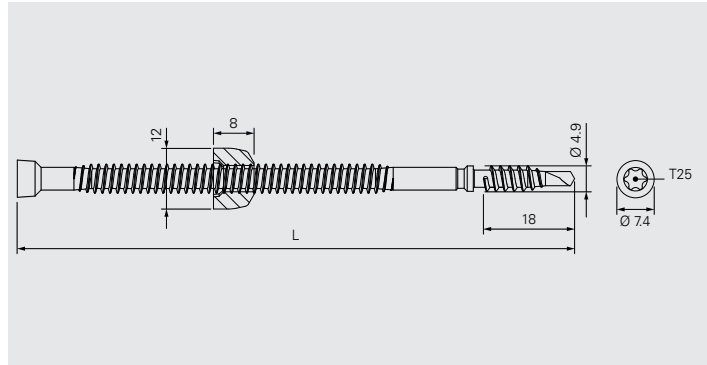

## Application

Adjustable carbon steel fastener for waterproof membrane and tapered insulation securement in combination with sleeve FI-R-20 on steel deck, with telescope-function.  
Pre-assembled with plastic nut.

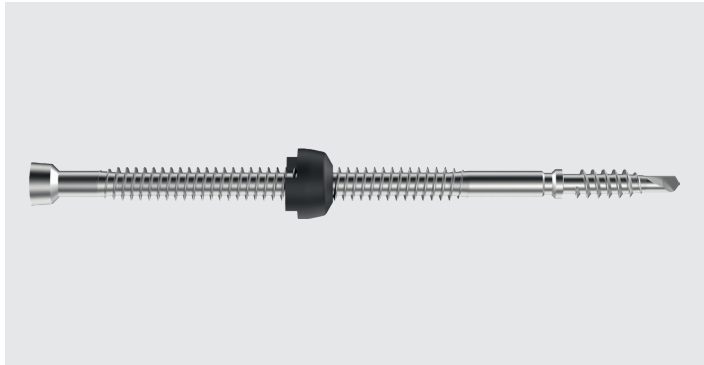
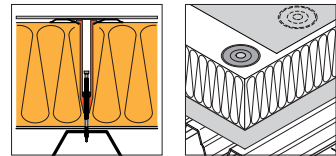

Substrate material quality: S235-S320GD  
Substrate material thickness: min. 0.7 mm  
max. 2x1.25 mm or 1x2.0 mm  
Setting depth: max. 20 mm

## Product Information

Material: Case hardened carbon steel

Corrosion protection: Durocoat®  
Resistance 15 cycles Kesternich test according to

- EAD 030351-00-0402, A2.4
- FM Approval Standard 4470

## Approvals/Assessments

**CE**<sub>08</sub>  
ETA-08/0262

Declaration of Performance (DoP)

## Features and Benefits

- Adjustable fastening system for tapered insulation with telescopic function
- Fewer product combinations required
- 20 mm fixed setting depth
- High quality corrosion protection, environment friendly, free of Chromium VI

## Product Range

### Loose fasteners, incl. plastic nut

Product Code	L mm	PU	Material No.
BSA-N-4,8×110	110	250	1621138
BSA-N-4,8×160	160		1621159

## Pre-assembled sleeve-fastener combination, fastener incl. plastic nut

Product Code	Clamping length CL		PU	Material No.
	min. mm	max. mm		
FI-R-20×70/BSA-N-4,8×110	100	120	250	1621140
FI-R-20×100/BSA-N-4,8×110	115	150		1621172
FI-R-20×130/BSA-N-4,8×110	145	180		1621173
FI-R-20×130/BSA-N-4,8×160	150	230		1621174
FI-R-20×160/BSA-N-4,8×160	175	260		1621175
FI-R-20×190/BSA-N-4,8×160	205	290		1621176
FI-R-20×230/BSA-N-4,8×160	245	330		1621177
FI-R-20×300/BSA-N-4,8×160	315	400		1621178
FI-R-20×350/BSA-N-4,8×160	365	450		1621180
FI-R-20×400/BSA-N-4,8×160	415	500		1621181

## Products to combine with

Product Code	Description	
FI-R-20	Sleeve for waterproof membrane and insulation securement. For isoweld® field fastening and seam fastening applications.	

## Tools and Accessories

Product Code	Description	
BSA500	Installation tool for adjustable fastening system with fastener BSA-N-4,8 and sleeve FI-R-20.	

## Recommendations for Installation

Operating process	Recommendation	
Screwing in	Power screwdriver <ul style="list-style-type: none"> <li>• 1000–3000 rpm</li> <li>• Min. 500 W</li> </ul> Battery tool <ul style="list-style-type: none"> <li>• 1000–3000 rpm</li> <li>• Min. 18 V</li> <li>• Battery with min. 2,5 Ah</li> </ul>	