

SDC5-6.3

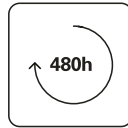
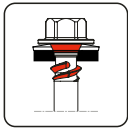
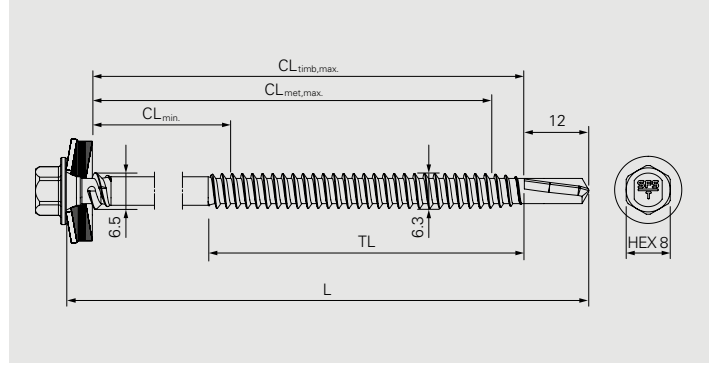
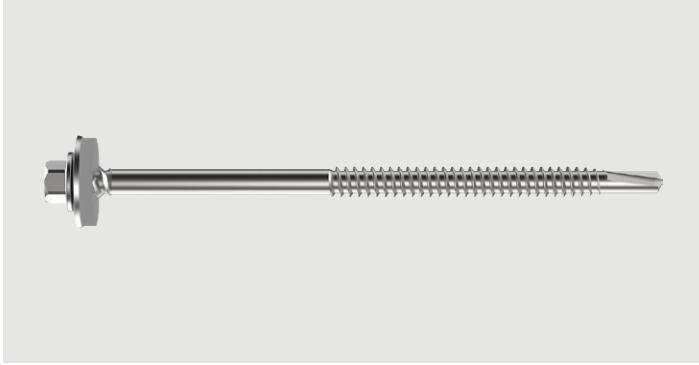

Application

- Fastening of sandwich panels onto metal profiles
- Fastening of sandwich panels onto timber
- Fastening of profile sheets onto metal profiles
- Fastening of profile sheets onto timber

Fastener material

- Carbon steel, Durocoat® 480
- Sealing washer: Carbon steel galvanized, EPDM-seal

Component 1 (t_1 / t_{NII})

Sandwich panel ≥ 0.40

Component 2 (t_{II})

Steel	1.0–4.0	5.0
Steel	2×0.75–2×2.70	6.50
Timber	$l_{ef} \geq 25$	–

$\Sigma_{max} t_1 + t_{II}$

Approvals



Features and Benefits

- Self drilling fastener suitable for installation of sandwich panels
- High quality EPDM sealing washer for long-term weather sealing
- Perfect supporting of the sandwich panel outer-skin given by support thread with cut-off thread-end
- Optimized support function achieved by engineered double support thread
- Easy drilling through overlapped metal profiles given by the long drill point
- High bending capacity for absorption of thermal expansion of the sandwich panel outer-skin
- High tension resistance achieved by optimized fastener geometry
- Economical benefits given by less fastener needed and installation time savings and / or optimized subconstruction

Documentation

Approval document (ETA) | Declaration of performance (DoP)

All measures in mm

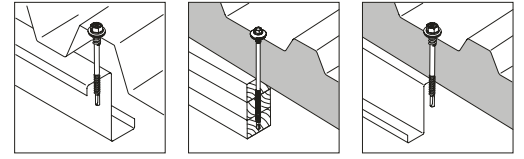

Fastener in carbon steel onto steel and timber

Product code	PU	L	CL _{met}	t _{fix, met}	CL _{timb}	t _{fix, timb}	TL	T16	T19
SDC5-T19-6,3×60	100	60	15-37	15-32/36	0-45	0-20	32	1685056	1685077
SDC5-T19-6,3×70		70	20-47	20-42/46	5-55	5-30	37	1685057	1685078
SDC5-T19-6,3×80		80	30-57	30-52/56	15-65	15-40		1685058	1685079
SDC5-T19-6,3×100		100	40-77	40-72/76	25-85	25-60		47	1685020
SDC5-T19-6,3×120		120	50-97	50-92/96	35-105	35-80	57	1685059	1685080
SDC5-T19-6,3×140		140	70-117	70-112/116	55-125	55-100		1685060	1685081
SDC5-T19-6,3×160		160	90-137	90-132/136	75-145	75-120		1685071	1685082
SDC5-T19-6,3×190		190	110-167	110-162/166	95-175	95-150	67	1685072	1685083
SDC5-T19-6,3×220		220	140-197	140-192/196	125-205	125-180		1685073	1685084
SDC5-T19-6,3×250		250	170-227	170-222/226	155-235	155-210		1685074	1685085
SDC5-T19-6,3×290		290	210-267	210-262/266	195-275	195-250		1685075	1685086

t_{fix, met}: CL_{met, min.} - (CL_{met, max.} - t_{tl, max.} or load-bearing clamping length according ETA)/(CL_{met, max.} - t_{tl, min.})

t_{fix, timb}: CL_{timb, min.} - (CL_{timb, max.} - l_{ef, min.})

All measures in mm

All information is non-binding and without guarantee. Before using the products, all specifications and calculations must be checked by a suitably qualified person and local regulations must be observed. This document is subject to revision. We reserve the right to make technical changes.

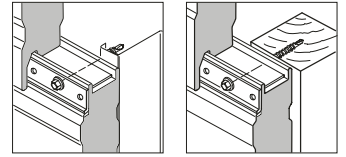

Fastener in carbon steel onto steel and timber

Product code	PU	L	CL _{met}	t _{fix, met}	CL _{timb}	t _{fix, timb}	TL	No washer
SDC5-6,3×60	100	60	18-40	18-35/39	0-48	0-23	32	1685087
SDC5-6,3×70		70	23-50	23-45/49	8-58	8-33	37	1679504
SDC5-6,3×80		80	33-60	33-55/59	18-68	18-43		1685088
SDC5-6,3×100		100	43-80	43-75/79	28-88	28-63	47	1685089
SDC5-6,3×120		120	53-100	53-95/99	38-108	38-83	57	1685090
SDC5-6,3×140		140	73-120	73-115/119	58-128	58-103		1685091
SDC5-6,3×160		160	93-140	93-135/139	78-148	78-123		1685092
SDC5-6,3×190		190	113-170	113-165/169	98-178	98-153	67	1685093
SDC5-6,3×220		220	143-200	143-195/199	128-208	128-183		1685094
SDC5-6,3×250		250	173-230	173-225/229	158-238	158-213		1685095
SDC5-6,3×290		290	213-270	213-265/269	198-278	198-253		1685096

t_{fix, met}: CL_{met, min.} - (CL_{met, max.} - t_{II, max.} or load-bearing clamping length according ETA)/(CL_{met, max.} - t_{II, min.})

t_{fix, timb}: CL_{timb, min.} - (CL_{timb, max.} - l_{ef, min.})



Accessories/Ancillaries

Product code	PU	Drive	Head drive	
SOK-IT-¼"-57-6Nm	1	¼"	SW8	1667323
SOK-IT-¼"-57-8Nm				1667322
E308-¼"-50		HEX8	1646160	

All measures in mm